



MADA ■
GYPSUM

ProGuard

SHEATHING BOARD



ProGuard HIGH PERFORMANCE SHEATHING SPECIFICATIONS

1

Treated gypsum core with coated fiberglass mat on both sides provides superior strength and water resistance

2

Ideal for use with most exterior cladding system

3

Score and snap cutting, easily worked with standard tools

4

Can be left exposed for up to 12 months after installation

5

Mould Resistant

6

Noncombustible rating when tested in accordance with BS EN 13501-1

Warranted Performance



Mada ProGuard glass mat sheathing is warranted against manufacturing defects for a period of 5 years, and damage from weather exposure for 12 months.*

Limitations

1. Mada ProGuard glass mat sheathing board shall not be used as a nail base for exterior cladding system.
2. The specific requirements for frame spacing, fastener spacing, and fastener details to provide lateral wind-load resistance are the responsibility of the project architect, engineer, or designer. (Refer to technical data and specifications on the following pages.)
3. Mada ProGuard glass mat sheathing is weather-resistant but is not designed for constant water exposure. If extreme weather exposure is a possibility, the design professional should consider installing a weather-resistant barrier.
4. Do not laminate panels to masonry surfaces or substrates, use furring or framing material for attachment purposes.
5. Maximum stud spacing is 600mm on center.
6. Mada ProGuard glass mat sheathing is not a finished surface.

ProGuard HIGH PERFORMANCE SHEATHING SPECIFICATIONS

Primary Uses

Mada ProGuard glass mat sheathing board can be specified for exterior walls, ceilings, and soffits in a wide variety of exterior applications:

- EIFS (Exterior Insulation Finish Systems)
- SFS infill
- Cladding systems such as wood/vinyl/composition siding, plywood panels, wood shingles/shakes, and conventional stucco finishes
- Interior finishes requiring a substrate panel with superior fire and moisture resistance



Product Characteristics



Length
standard lengths: 2400mm



Thickness
12.5 mm



Width
1200 mm



Color
Light blue on face and light blue/white on back side



Edge detail
Square



Fire rating
(Using Mada System application)
Tested in accordance with BS EN13501-1

Fastening and Framing

Thickness	Framing Spacing	Panel Orientation	Fastener Spacing-Metal Framing ^c
12.5mm	600mm o.c. max ^{a,b}	Parallel or Perpendicular	200mm o.c. along framing

- Only for mechanically attached claddings. When specified behind EIFS, maximum framing spacing for single layer 12.5mm Mada ProGuard glass mat sheathing is 40 mm o.c.
- For racking strength resistance, apply panel edges parallel with framing spaced a maximum of 400 mm o.c. for 12.5mm Mada ProGuard glass mat sheathing.
- Fire-rated assemblies may require additional fasteners, see specific assembly details.

ProGuard PROPERTIES



A1 Non Combustible



10 years System Warranty*



Mould & Moisture Resistance



Pest resistance



Improved Insulation (U-Values) and Energy Efficient



Lightweight



Ease of Installation

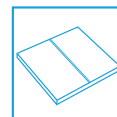

Score & snap

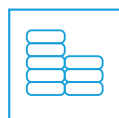

Cost Saving Solution



Excellent Weather Exposure

Parameters	Applicable standard	ProGuard Board Thickness
		12.5mm
Weight (kg/m ²)	+ 0.2	10.6
Board Density (kg/m ³)	Minimum	832
Flexural Strength (N) (Longitudinal)	EN 15283-1:2008	≥ 537.5
Flexural Strength (N) (Transverse)	EN 15283-1:2008	≥ 210
Nail Pull Resistance (N)	EAD 090062-00-0404	≥ 356
Water Absorption (%)	EN 15283-1:2008	H1
Flame Spread Index	EN13501-1	25 or less
Smoke Developed Index	EN13501-1	450 or less
Asbestos (% by weight)	-	No asbestos fibers detected

RECOMMENDATIONS

1. Installed Mada ProGuard glass mat sheathing board must be covered by the exterior cladding system within a 12-month period.
2. Mada ProGuard glass mat sheathing board is water-resistant, but it's not suitable for prolonged exposure to rainfall.
3. Framing and application details and requirements shall be determined from the weather-resistant barriers, cladding, structural assemblies, and fire-resistance requirements for the project, and must be approved by the project architect, engineer, or designer.
4. Avoid conditions during construction that could result in an excessive moisture load inside the building. Items such as forced-air heaters, masonry, or concrete pouring and finishing produce large volumes of water vapor, which can condensate in unfinished exterior wall cavities. Use ventilation or dehumidification to reduce moisture levels below the dew point of the outside air. Any damage resulting from improper moisture management is not the responsibility of Mada Gypsum.
5. Panels are heavy and could fall over causing injury or death. Always store panels flat, unless directed otherwise by the site manager to eliminate tripping hazard or avoid point overloading of the floor structure.



INSTALLATION INSTRUCTIONS

- Mada ProGuard glass mat sheathing board must be installed in accordance with this brochure's instructions, and EN15823-1:2008. Panels may be attached perpendicular or parallel to the framing system. Use the correct board orientation for specific fire assemblies and shear wall applications within this document, other reference documents, or as required by the design authority. Framing stud flanges shall not measure less than 32mm for steel framing applications. Framing members shall not vary more than 3mm from the face plane of adjacent framing.
- Fasteners shall not be countersunk, but flush to the panel face and into the framing element. Locate fasteners at least 10mm from sheathing ends and edges. Nails or screws listed in the fastener chart can be used to attach panels to framing system. Consult with manufacturer for application specifications and shear resistance data when using pneumatic fasteners.
- Install Mada ProGuard glass mat sheathing using staggered joints to fit panel ends and edges together tightly. Align joints (when possible) with edge of openings, and properly flashed around the perimeter of the opening. Consult with the project architect, engineer, or designer for control joint recommendations.
- Panels may be installed vertically or horizontally, except when limited by other specific requirements. Panel orientation is dictated by fire-rated construction assemblies.
- Panels can be cut by sawing, or by using the score and snap method. When using a power saw, a cordless low-RPM saw will generate far less airborne particles than a standard corded saw.
- Properly trim any cuts to create neatly fitting joints once installed.
- Holes for pipes, penetrations, and devices shall be scored or saw-cut from the panel face before removing cutout material.
- All vertical ends and edge joints should be centered on framing member and offset a minimum of one framing cavity between adjacent panel rows. Fit panels tightly without forcing them together.
- Hold panels in firm contact with framing components and attach with specified fasteners. Fasteners should be driven flush with panel, do not countersink or break surface of the Mada ProGuard glass mat sheathing panel. Attach panel to framing starting in the center and working outwards to the edges. The maximum fastener spacing is 300mm to the plain and 200mm to the perimeter, and a minimum of 10mm from any edge or end of the panel.
- Supplemental use of panel adhesive will strengthen the connection and fill in minor surface irregularities, resulting in a smoother finish surface. The use of adhesive does not reduce the number of fasteners required. For optimal adhesive bond, apply per manufacturers recommendations. Framing elements must be free of oil or dirt, and panel must be clean and dry.
- Panels should fit snugly around door and window openings. Offset panel joints a minimum of 100mm from the edge of openings to reduce potential stress cracking. Refer to the weather-resistive barrier or exterior cladding system manufacturer for specific installation requirements.
- To prevent water intrusion, flash all openings (head, sill, etc.) and all roof/wall intersections properly.
- Panels shall maintain a 6mm gap at masonry or other water retaining materials to prevent wicking.
- Install panels a minimum of 200mm above finish grade in a weather and water protected cladding system and in properly drain and ventilated crawl spaces.
- Where panels meet horizontal surfaces such as slabs, foundation walls, or roof assemblies, gap panels 6mm to 12.7 mm above the intersecting surface. Fill gap with approved sealant to prevent moisture from absorbing into panel.

ASSEMBLY OPTIONS

Exterior Cladding

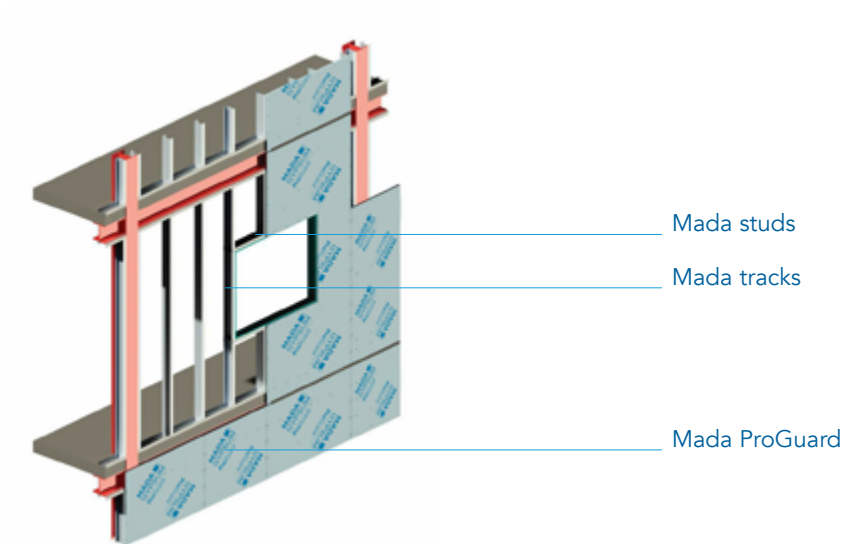

LGS Wall System

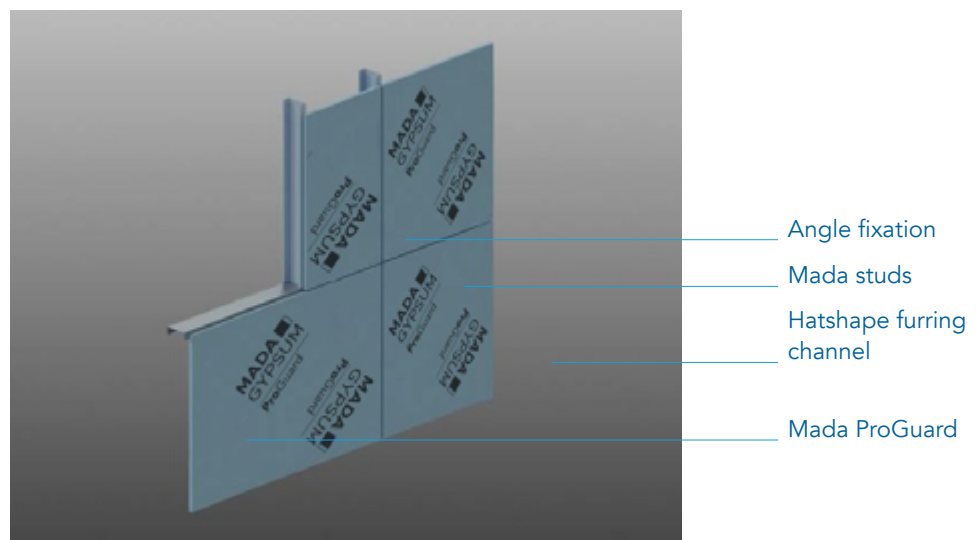



Head Office: IPP Ltd, Bradwell Hall, Bradwell on Sea, Essex, CM0 7HX

Tel: 01621 776252

www.inpetro.com